

All designs, ideas, arrangements and plans indicated by these drawings are the property and copyright of the architect and shall neither be used nor any other work nor be disclosed to any other person for any use whatsoever without written permission.

Hanson/Architecture and its principals and employees waive any and all liability or responsibility for problems that may occur when these plans, drawings, specifications, and/or designs are followed without the professional's guidance with ambiguities, or conflicts which are alleged.

OWNER / CLIENT

**Javier's**  
5366 Spectrum Center Dr  
Irvine, CA 92617  
T 949 939 8711

ARCHITECT

**hansonla**  
ARCHITECTURE  
13160 Mindanao Way  
Suite 1000  
Marina Del Rey, CA 90292  
T 213 880 8515

INTERIOR DESIGNER

**AG**  
ATELIER GULLA JONSDOTTIR  
1543 Marwood Ave.  
Los Angeles, CA 90069  
T 213 922 5091

CONTRACTOR

**PKJ CONSTRUCTION**  
23307 La Palma Ave  
Yorba Linda, CA 92887  
T 714 455 2997

STRUCTURAL ENGINEER

**JOHN A. MARTIN & ASSOCIATES**  
950 South Grand Avenue,  
Suite 400  
Los Angeles, CA 90015  
T 213 785 3148

MEP ENGINEER

**LINWOOD ENGINEERING INC**  
2201 Dupont Dr  
Suite 150  
Irvine, CA 92612  
T 714 424 0001

LIGHTING CONSULTANT

**LIGHTING DESIGN ALLIANCE**  
2800 Temple Avenue  
Long Beach, CA 90806  
T 562 899 3843

CIVIL ENGINEER

**kpff**  
140 Newport Center Drive,  
Suite 100  
Newport Beach, CA 92660  
T 949 478 8804

LANDSCAPE

**[place]**  
9617 Exposition Blvd  
Los Angeles, CA 90016  
T 310 450 8100

STAMP

BAR SCALE

SHEET REVISION

ISSUE	DATE
90% CONSTRUCTION DOCUMENTS	01.27.2023
PLAN CHECK RESUBMISSION	01.26.2023
ADDENDUM TO GC REVIEW SET	12.22.2022
ISSUE FOR AN CHECK	11.22.2022
90% CONSTRUCTION DOCUMENTS	11.14.2022
100% DESIGN DEVELOPMENT	09.21.2022
50% DESIGN DEVELOPMENT	09.02.2022
100% SCHEMATIC DESIGN	06.03.2022
50% SCHEMATIC DESIGN	07.18.2022
ISSUE	DATE

SITE PLAN

SCALE: As indicated

A050.2

DATE

02.06.2023

© 2023 HANSONLA

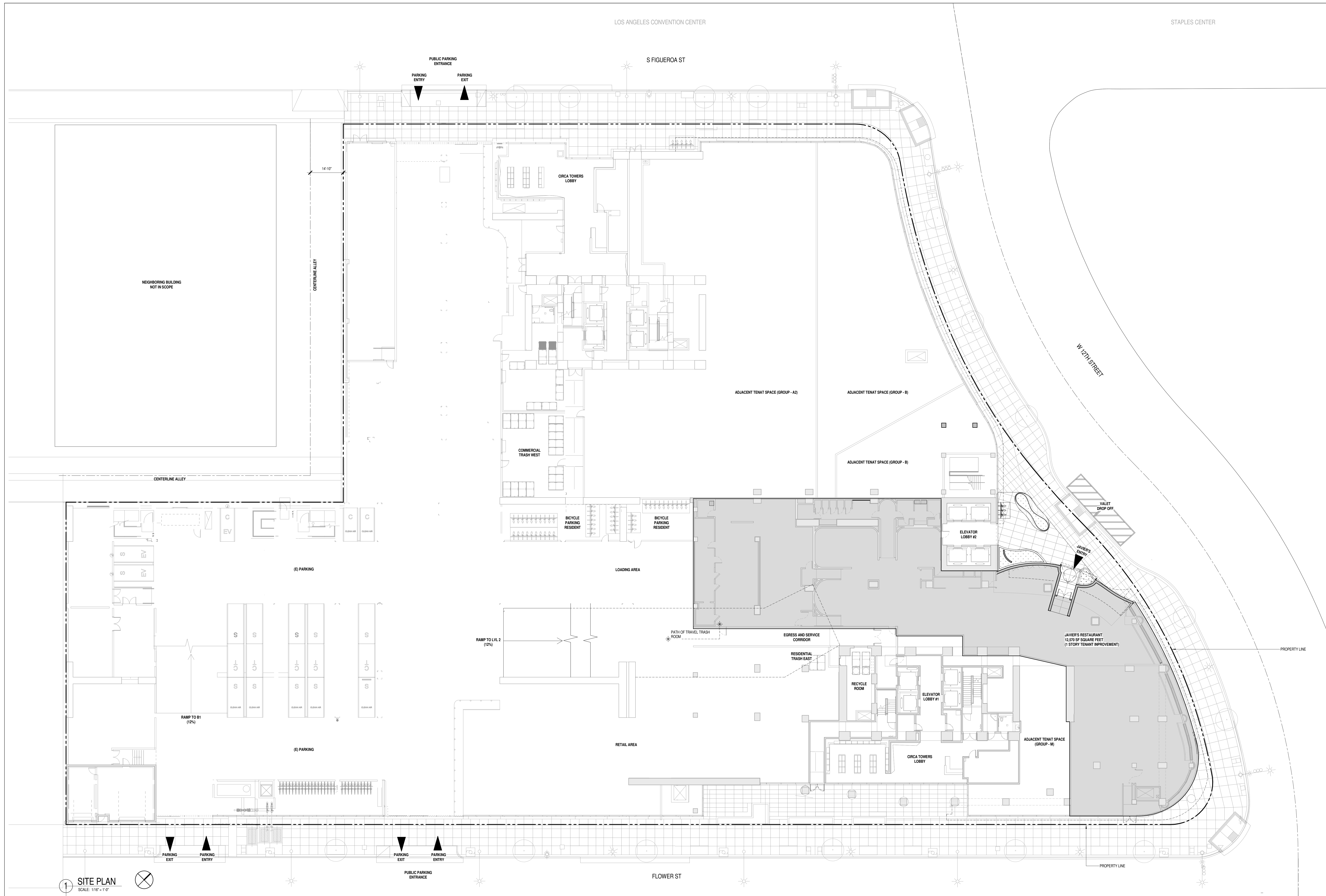

1 SITE PLAN  
SCALE: 1/16" = 1'-0"

GENERAL NOTES

- BUILDING ADDRESS SHALL BE PROVIDED AT THE ENTRANCE OF THE BLDG IN ACCORDANCE WITH LAMC 57.09.11
- TEMPORARY PEDESTRIAN PROTECTION SHALL BE PROVIDED AS REQUIRED PER SEC 3306. OBTAIN PUBLIC WORKS' APPROVAL.
- THE CONSTRUCTION SHALL NOT RESTRICT A FIVE FOOT CLEAR AND UNOBSTRUCTED ACCESS TO ANY WATER OR POWDER DISTRIBUTION FACILITIES (POWER POLES, PULL BOXES, TRANSFORMERS, VALVES, PUMPS, VALVES, METERS, APPURTENANCES, ETC.) OR TO THE LOCATION OF THE HOUSING. THE CONSTRUCTION SHALL NOT BE WITHIN 10 FEET OF ANY POWER LINES, WHETHER OR NOT THE LINES ARE LOCATED ON THE PROPERTY. FAILURE TO COMPLY MAY CAUSE CONSTRUCTION DELAYS AND/OR ADDITIONAL EXPENSES.
- THIS BUILDING SHALL BE PROVIDED WITH A MANUAL ALARM SYSTEM WITH THE CAPABILITY TO SUPPORT VISIBLE ALARM NOTIFICATION APPLIANCES IN ACCORDANCE WITH NFPA 72.
- ALL ROOF DRAINS AND AREA DRAINS OPEN TO SKY SHALL DISCHARGE INTO BMP DEVICES PER LID PLANS
- ALL TRASH BINS SHALL BE COVERED.



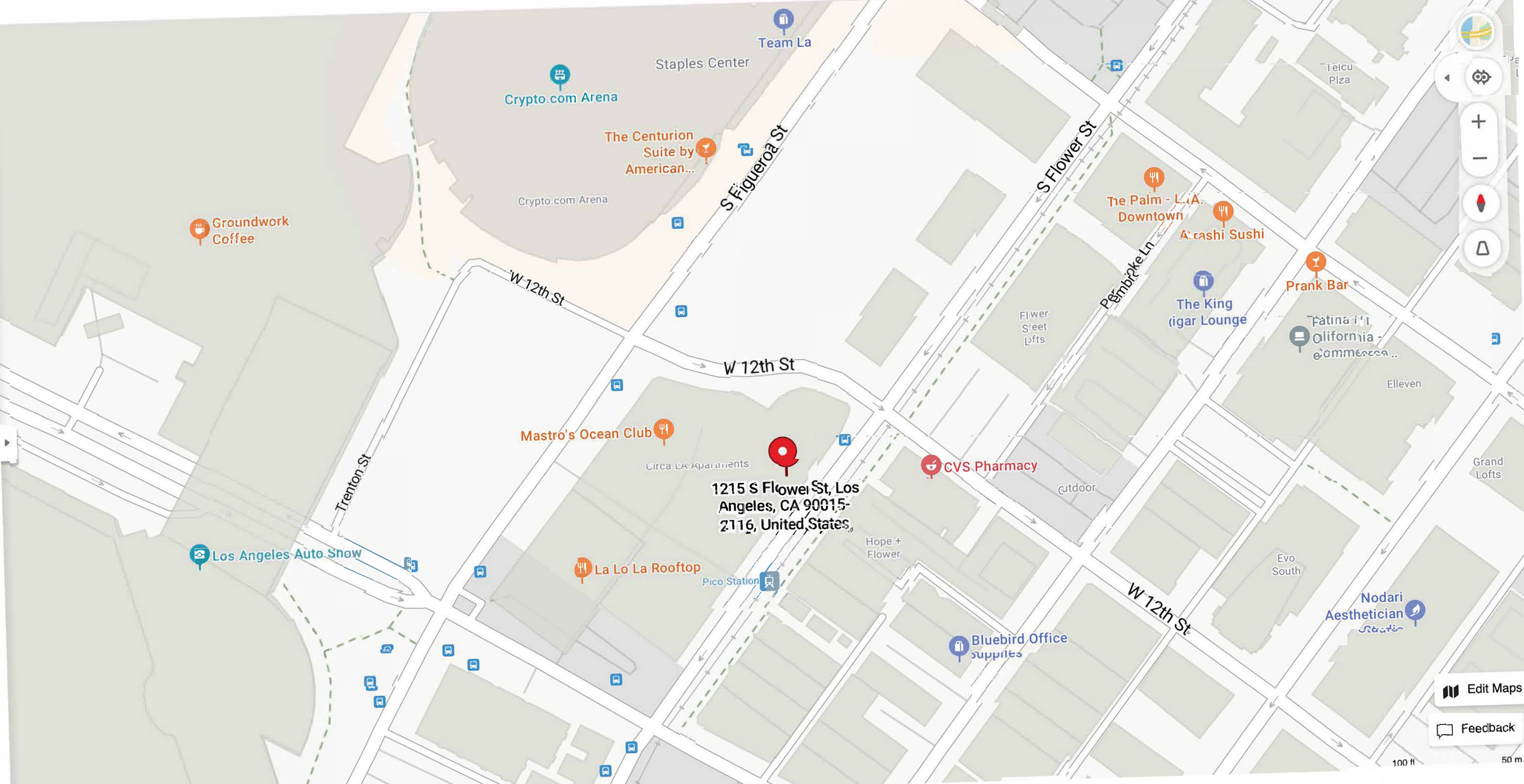

1215 S Flower St, Los Angeles, CA 90015-2116, United States

Crypto.com Arena

Staples Center

Team La

The Centurion Suite by American...

Groundwork Coffee

The Palm - L.A. Downtown

A. rashi Sushi

The King cigar Lounge

Prank Bar

Fatima's California - eommencea...

Elleven

Mastro's Ocean Club

Circa LA Apartments

CVS Pharmacy

Los Angeles Auto Show

La Lo La Rooftop

Pico Station

Bluebird Office supplies

Nodari Aesthetician

Edit Maps

Feedback

100 ft

50 m



**JAVIER'S RESTAURANT**

1200 S Figueroa St  
Suite C  
Los Angeles, CA 90015

# JAV\_220601

All designs, ideas, arrangements and plans indicated by these drawings are the property and copyright of the architect and shall neither be used, or any other work not be designed to any other person for any use whatsoever without written permission.

Hanson A. Architecture and its principals and employees waive any and all liability or responsibility for problems that may occur when these plans, drawings, specifications, and/or designs are followed without the professional's guidance with any applicable, or conflicts which are alleged.

OWNER / CLIENT  
**Javier's**  
5355 Spectrum Center Drive  
Irvine, CA 92617  
T 949 939 9711

ARCHITECT  
**hansonla ARCHITECTURE**  
13162 Miradeno Way  
Suite 1000  
Marina Del Rey, CA 90292  
T 310 880 8515

INTERIOR DESIGNER  
**AGJ**  
1543 Marmont Ave.  
Los Angeles, CA 90029  
T 323 822 5061

CONTRACTOR  
**PKJ CONSTRUCTION**  
23307 La Palma Ave.  
Yorba Linda, CA 92887  
T 714 455 2987

STRUCTURAL ENGINEER  
**JOHN A. MARTIN & ASSOCIATES**  
950 South Grand Avenue,  
Suite 400  
Los Angeles, CA 90015  
T 213 785 3148

MEP ENGINEER  
**LE LINWOOD ENGINEERING INC**  
2201 Dupont Dr  
Suite 100  
Irvine, CA 92612  
T 714 424 0001

LIGHTING CONSULTANT  
**LIGHTING DESIGN ALLIANCE**  
2630 Temple Avenue  
Long Beach, CA 90806  
T 562 989 3843

CIVIL ENGINEER  
**kpff**  
140 Newport Center Drive,  
Suite 100  
Newport Beach, CA 92660  
T 949 478 8804

LANDSCAPE  
[ place ]  
3817 Exposition Blvd  
Los Angeles, CA 90016  
T 310 450 8100

STAMP

BAR SCALE

SHEET REVISION DATE

90% CONSTRUCTION DOCUMENTS	01.25.22
ADDENDUM TO GC REVIEW SET	12.21.22
ISSUES FOR PLAN CHECK	11.16.22
50% CONSTRUCTION DOCUMENTS	11.14.22
100% DESIGN DEVELOPMENT	09.21.22
50% DESIGN DEVELOPMENT	09.02.22
100% SCHEMATIC DESIGN	08.03.22
50% SCHEMATIC DESIGN	07.18.22
ISSUE	DATE

**FURNITURE PLAN**

**ID-F1-3.00**

DATE 01.25.2022 © 2022 HANSONLA

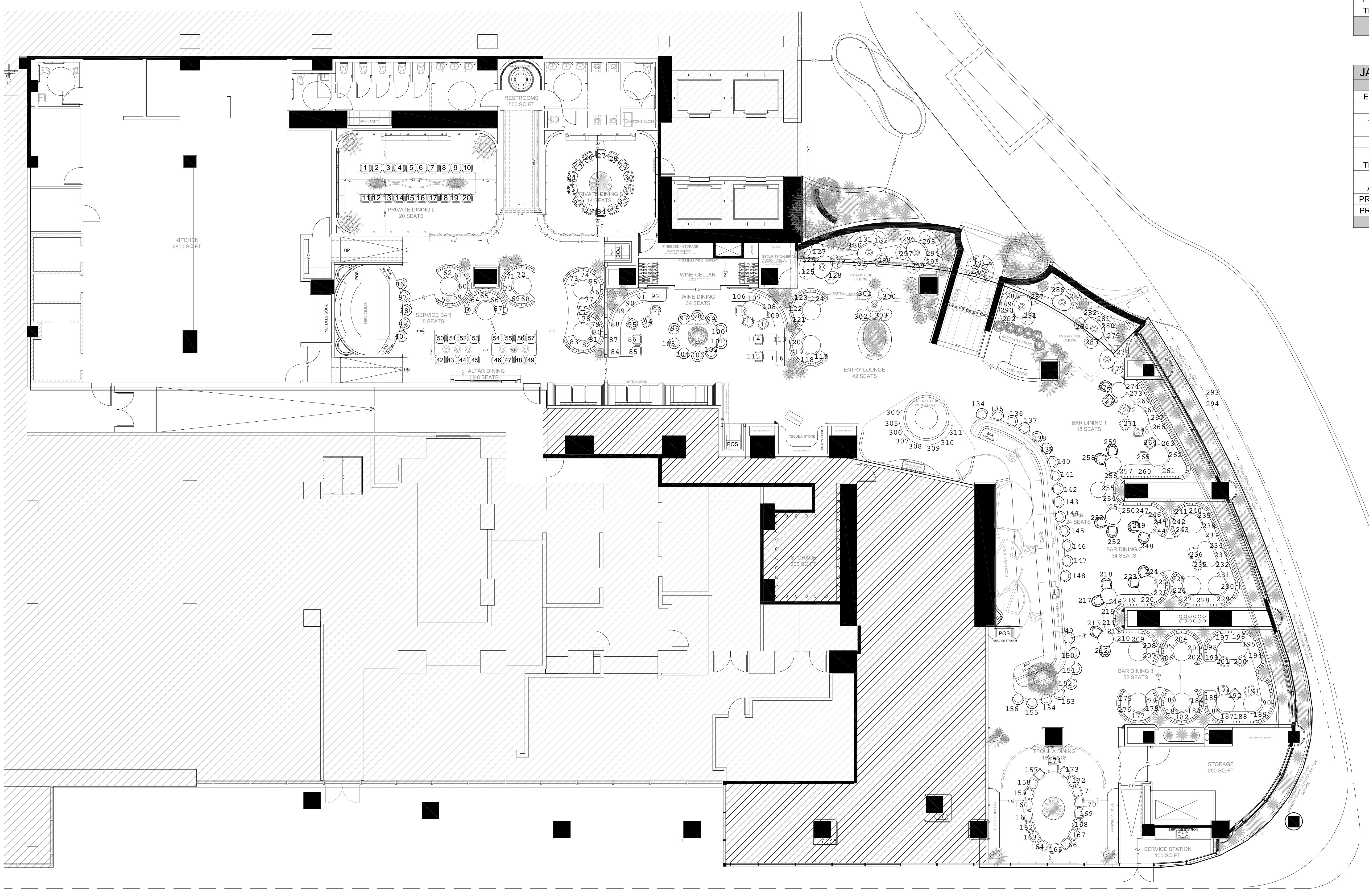

1ST FLOOR - FURNITURE PLAN 1  
SCALE: 1/8"=1'-0"

JAVIER'S DOWNTOWN	
TYPE	SEATS
LOUNGE	42
BAR	29
DINING	186
PRIVATE DINING	36
TEQUILA DINING	18
TOTAL	311

JAVIER'S DOWNTOWN	
ROOM	SEATS
ENTRY LOUNGE	42
BAR	24
SERVICE BAR	5
BAR DINING 1	18
BAR DINING 2	34
BAR DINING 3	52
TEQUILA DINING	18
WINE DINING	34
ALTAR DINING	48
PRIVATE DINING S	14
PRIVATE DINING L	22
TOTAL	311